

268 Belmore Road Riverwood NSW

Situated on 209 sqm and located in the heart of Riverwood shopping village & transport hub, this partially renovated property is ideal for a business owner or an astute investor. Providing you with excellent main road exposure, rear lane access with off street parking & adjacent to a public carpark, this is a opportunity not to be missed!

Features include:

SHOP

- * Area - 62m2 (Approx)
- * Open plan
- * Fully tiled
- * Bathroom facilities
- * Rear lane access with 2 x lock up garages

UNIT

- * Area - 58m2 (Approx)
- * 2 Bedrooms
- * Separate entrance on Belmore Road

* All information contained herein is gathered from sources we believe to be reliable. However, we cannot guarantee its accuracy and interested persons should rely on their own enquiries.

[For full version visit the website](https://www.aspirepropertyagents.com.au)

Type : Retail
Building Size : 120 sqm
Land Size : 209 sqm
View : <https://www.aspirepropertyagents.com.au/8504808>



Sam Ayache
02 8507 2044

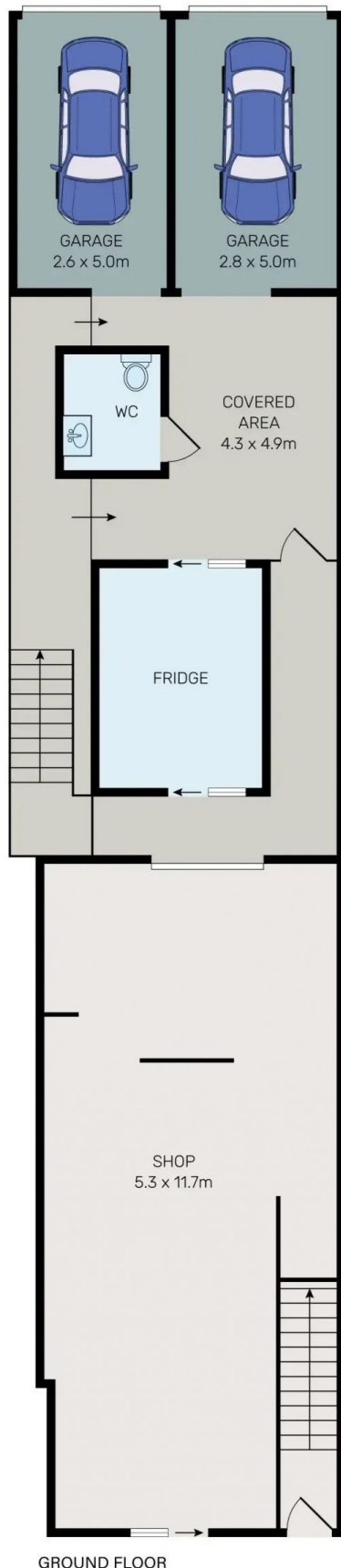

GROUND FLOOR

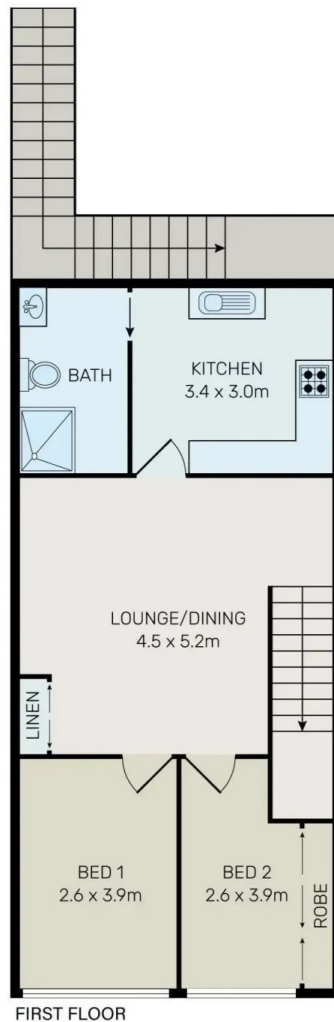

FIRST FLOOR



All information contained herein is gathered from all sources we believe to be reliable. However we cannot guarantee its accuracy and interested parties should rely on their own enquiries.



268 Belmore Road, Riverwood

